

12246 Music stand light

» Double4 LED FlexLight«

1. Equipment & Dimensions

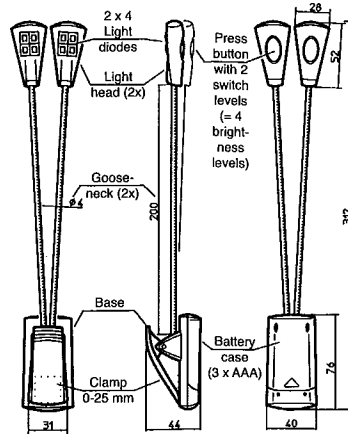

2. Batteries/rechargeable batteries insert or change

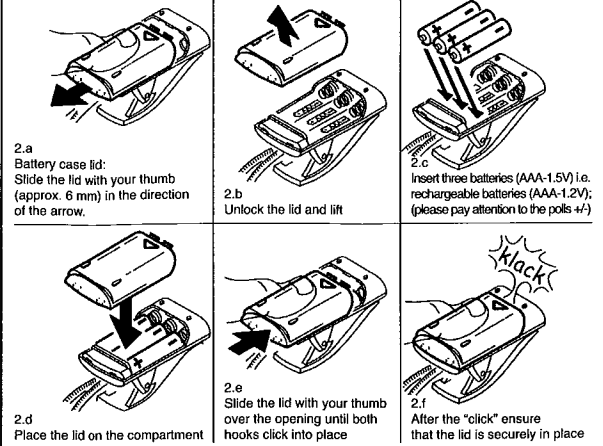

3. Placement of the lamp

3.a to the PLATES

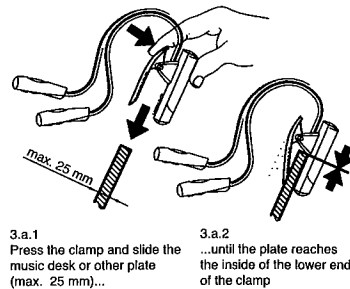

3.b to K&M-NOTE HEADS

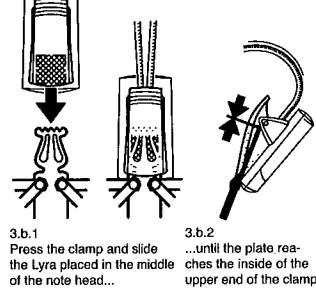

3.c on TABLES and TRAYS

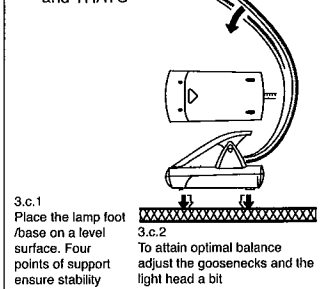

4. Turn Light On/Off

Both light heads can be turned on or off independently of each other

By repeated pressing of the press button the brightness is controlled:

Initial position = Light OFF

Press 1x
= full brightness

Press 2x
= less brightness

Press 3x
= Light is turned OFF

The switching cycle begins again

5. Adjust the Light Head

