

## Technical Manual

# JBL STX828S

## SPECIFICATIONS



### ACOUSTIC & ELECTRICAL SPECIFICATIONS:

- Nominal Impedance:
  - Parallel: 4 Ohms
  - Discrete: 8 Ohms x 2 Ohms
- Power Rating: Continuous / Program / Peak:
  - Parallel: 2000W / 4000W / 8000W
- Frequency Response: 37 Hz - 120 Hz ( $\pm 3$  dB)
- Frequency Range: 32 Hz - 250 Hz (-10 dB)
- Maximum SPL: 138 dB SPL peak
- System Sensitivity: 99 dB SPL (1 Watt @ 1 Meter)
- Recommended Crossover
  - Frequencies: 30 Hz, 24 dB / octave HPF
  - 80 Hz, 24 dB / octave LPF

### SYSTEM COMPONENTS:

- Cabinet: Enclosure (Not For Sale)
- Grille: 5013222
- Low Frequency Transducer: (2) 2242HPL, 457 mm (18 in) Super Vented Gap Cooled™ woofers
- DC Resistance: 4.7 ohm

### SYSTEM COMPONENTS: (CONT'D)

- Terminal Cup: 353601-001

### AURAL SWEEP TEST SPECIFICATIONS:

- A. System Aural Sweep Test: 10.0V Input, 20 Hz to 20 kHz
- B. L.F. Aural Sweep Test: 7V Input, 20 Hz to 1000 Hz

### PHYSICAL SPECIFICATIONS:

- Enclosure Dimensions: 564 x 1137 x 714 mm D (22.2 x 44.8 x 28.1 in. D)
- Net Weight: 180 lb (82 kg.)

### WARRANTY INFORMATION:

- Refer to Warranty Statement packed with each product.

## PACKAGE

Warranty 59660

Spec Sheet  
5022493

Carton  
5018505

Filler (2)  
5018506

PKG, Microfoam (8)  
49790P

Tray (2)  
5022559

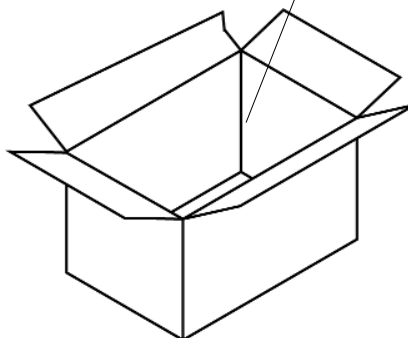

## WIRING DIAGRAM

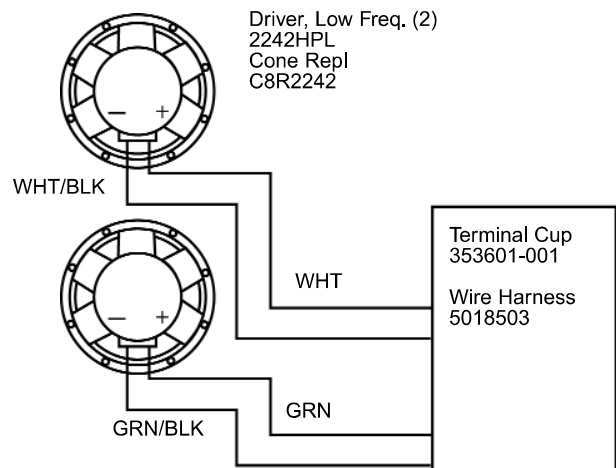

Wire Harness Diagram - 5018503

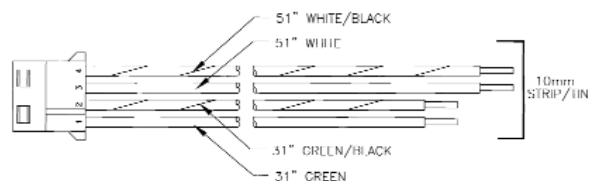

NOTE: INDIVIDUAL PARTS FOR THE ABOVE CROSSOVER ARE NOT AVAILABLE. A COMPLETE REPLACEMENT ASSEMBLY SHOULD BE ORDERED.

JBL STX828S REV B

# JBL STX828S

## COMPONENT EXPLODED VIEW

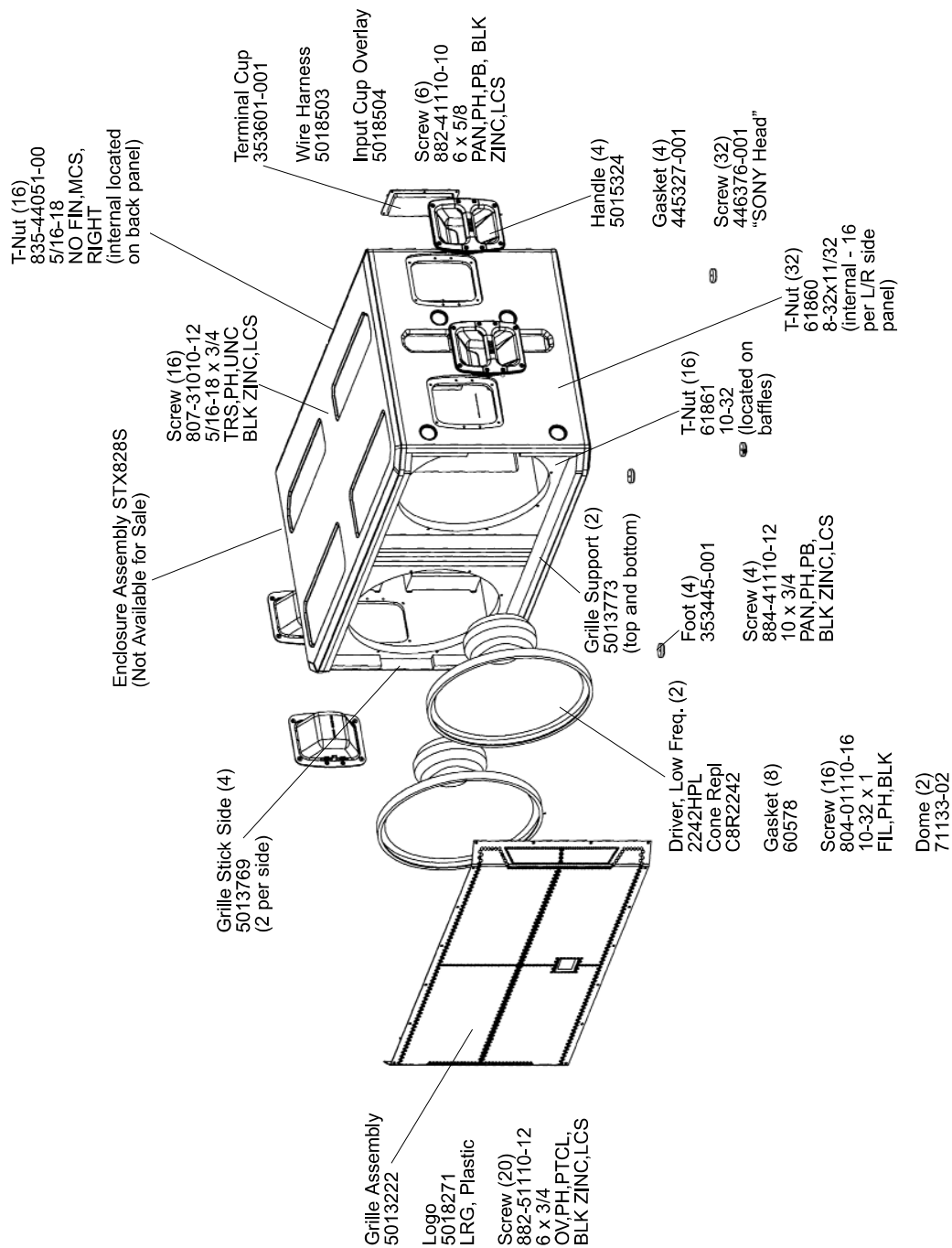

JBL STX828S